

01

Existing

EXISTING PARKING BAYS SHIFTED APPROX. 2.2 M

NEW SIGNAGE 'HIGHLANDS COURT'

NEW GREEN SPACE INTRODUCED

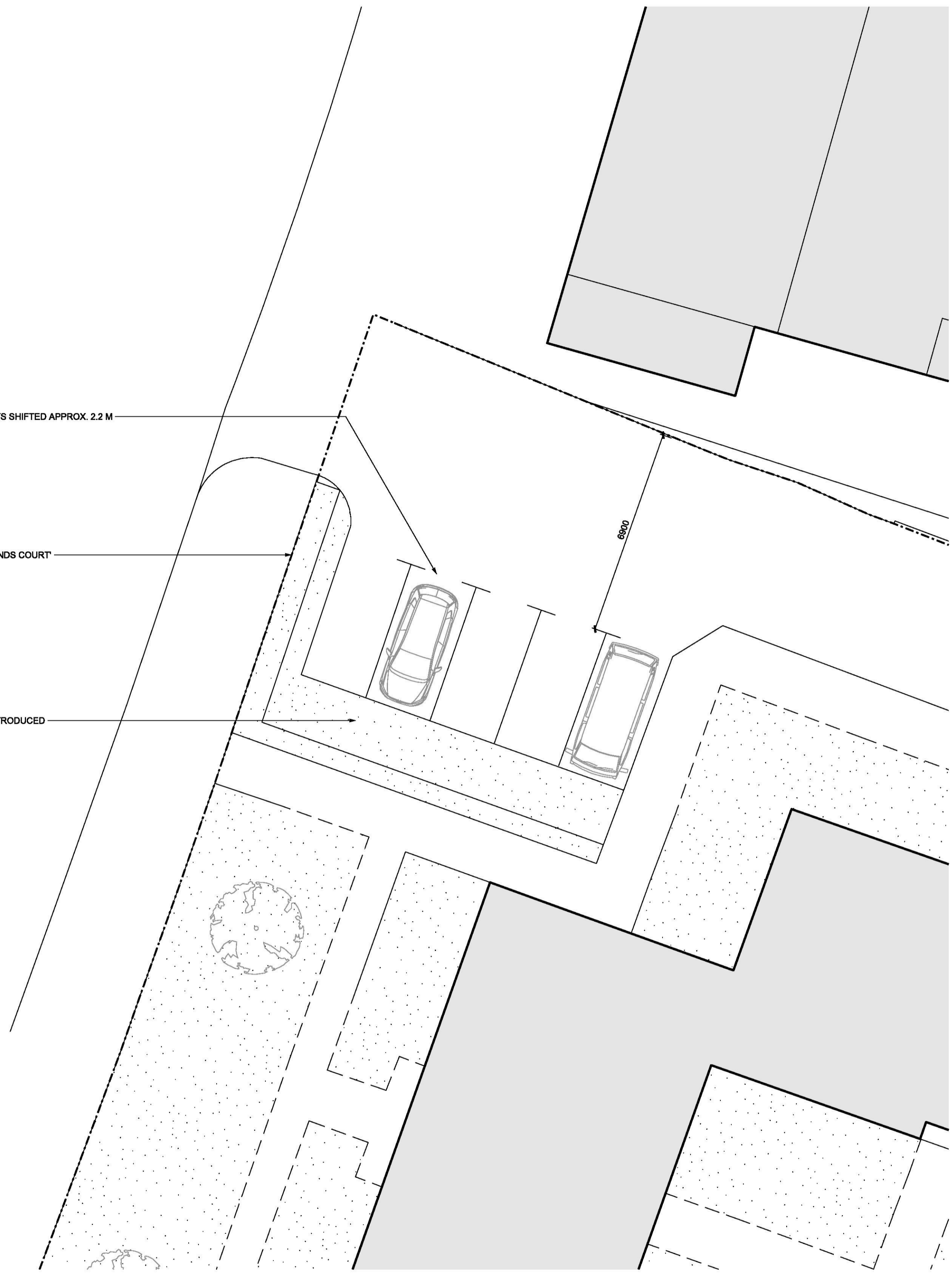

02

Proposed

Drawing Purpose For Planning			Revision Date Description - 22-02-2019 For Planning	Legend	Key Plan	Architect Collective Works LLP 8 Mackintosh Lane London, E9 6AB http://www.collectiveworks.net	Project 0103 Highlands Court Highlands Court Southend-on-Sea Leigh-on-Sea SS9 2SL	Drawing Title © copyright Collective Works LLP, all rights reserved 2019 Existing and Proposed Plans Site Entrance		
Drawn by TT	Checked by TT	Authorised by KH				Landscape Architect Design Studio 31 LTD 22 Bardfield Centre Great Bardfield, CM7 4SL hello@designstudio31.co.uk http://www.designstudio31.co.uk	Client Hollowell Ltd.	Scale @ A1 1:100	Drawing Number CW-0103-105	
<small>Do not scale from drawing. The author of this drawing takes no responsibility for any dimensions obtained by measuring or scaling from this drawing and no reliance may be placed on such dimensions. If no dimension is given, it is the responsibility of the recipient to ascertain the dimension specifically from the author or by site measurement. The sizing of all structural and service elements must always be checked against the relevant engineer's drawings. No reliance should be placed upon sizing information shown on this drawing.</small>						Planning Consultant Plainview Planning LTD Clarendon House, 42 Clarence Street Cheltenham, Gloucestershire, GL50 3PL enquiries@plainview.co.uk http://www.plainview.co.uk		Drawing Date 22-02-2019	Revision Date -	Revision -